

## CMR2S-02 CMR2S-04 CMR2S-06

### 2.0A, 200V, 400V and 600V Super Fast Rectifiers in the SMB package



Central Semiconductor's CMR2S-02 (200V), CMR2S-04 (400V) and CMR2S-06 (600V) devices are 2.0 amp surface mount super fast recovery rectifiers designed for commercial, industrial, computer, and automotive applications. These rectifiers have very low switching losses and are optimized for high speed, energy sensitive applications.

#### Features:

- Extremely fast switching speed ( $t_{rr} = 23\text{ns}$ )
- High reverse voltage ( $V_{RRM}$ )
- Glass passivated chip provides superior isolation
- Optimized for low leakage current ( $I_R$ )

#### Applications:

- Flyback diode
- Power factor correction
- DC-DC output rectification

#### Benefits:

- Minimal switching losses
- Space saving SMB package

#### Literature



New  
SMD  
SELECTION  
GUIDE

Order your selection guide today.  
Visit: [web.centrasemi.com/search/sample.php](http://web.centrasemi.com/search/sample.php)

#### Typical Electrical Characteristics

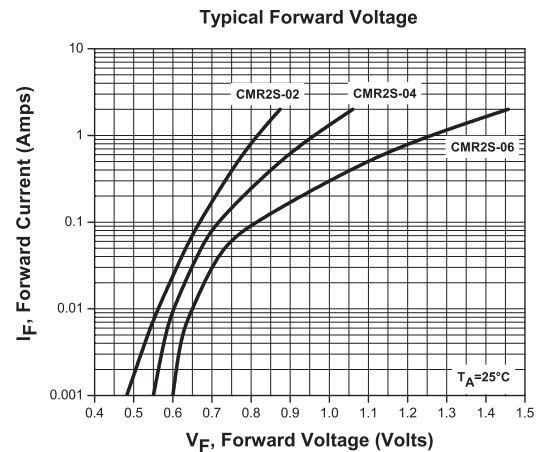

#### Samples



To order samples of this device visit:  
[www.centrasemi.com/info/CMR2S](http://www.centrasemi.com/info/CMR2S)

weblink scan

Use QR reader  
for direct link to  
product web page.



Electrical Characteristics: ( $T_A = 25^\circ\text{C}$ unless otherwise noted)										Thermal Characteristics	
Part No.	$V_{RRM}$ (V) MAX	$I_O$ (A)	$I_{FSM}$ (A) MAX	$V_F$		$@ I_F$ (A)	$I_R$ ( $\mu\text{A}$ ) MAX	$@ V_{RRM}$ (V)	$t_{rr}$ (ns) TYP	$T_J, T_{stg}$ ( $^\circ\text{C}$ ) MAX	$\Theta_{JA}$ ( $^\circ\text{C}/\text{W}$ ) MAX
				(V) TYP	(V) MAX						
CMR2S-02	200	2.0	50	0.88	0.95	2.0	1.0 150	200 ( $T_A = 100^\circ\text{C}$ )	23	-65 to +150	20
CMR2S-04	400	2.0	50	1.1	1.25	2.0	1.0 150	400 ( $T_A = 100^\circ\text{C}$ )	23	-65 to +150	20
CMR2S-06	600	2.0	50	1.5	1.7	2.0	1.0 150	600 ( $T_A = 100^\circ\text{C}$ )	23	-65 to +150	20

**CMR2S-02  
CMR2S-04  
CMR2S-06**

**2.0A, 200V, 400V and 600V  
Super Fast Rectifiers  
in the SMB package**

**Mechanical Drawing - SMB**

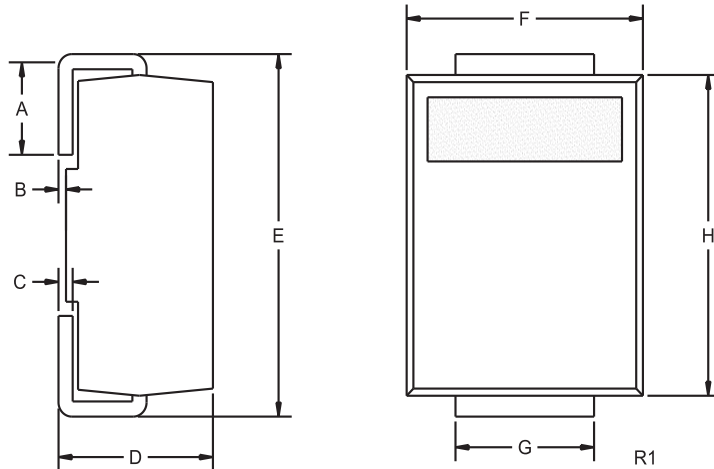

SYMBOL	INCHES		MILLIMETERS	
	MIN	MAX	MIN	MAX
A	0.030	0.060	0.76	1.52
B	0.004	0.008	0.10	0.20
C	0.006	0.012	0.15	0.30
D	0.086	0.096	2.18	2.44
E	0.200	0.220	5.08	5.59
F	0.130	0.150	3.30	3.81
G	0.077	0.083	1.96	2.11
H	0.160	0.180	4.06	4.57

DEVICE	MARKING CODE
CMR2S-02	CSF22
CMR2S-04	CSF24
CMR2S-06	CSF26

**Mounting Pad Geometry**  
(Dimensions in mm)

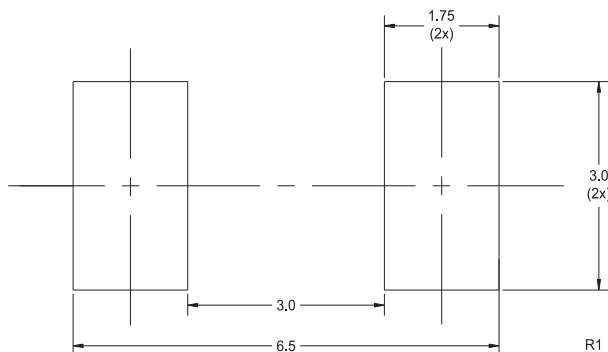

**Tape Dimensions and Orientation**  
(Dimensions in mm)

Tape Width: 12mm

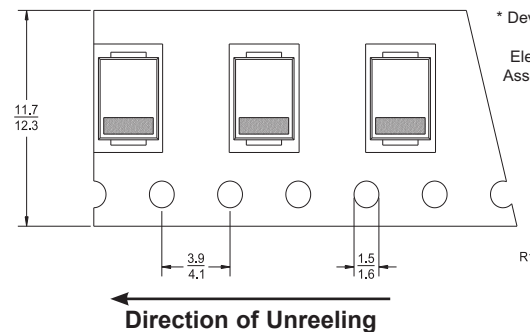

\* Devices are taped in accordance with Electronic Industries Association Standard EIA-481-1-A

**Packaging Base / Ordering Information**

Reel Size	Quantity	Central Item No.
13"	3,000 pcs.	CMR2S-02 TR
		CMR2S-04 TR
		CMR2S-06 TR

**Reel Packing Information**

Reel Size	Reels per Box (Maximum)	Parts per Box (Maximum)	Box Dimensions		Shipping Weight (Max.)	
			INCH	CM	LB	KG
13"	5	15,000	15x4x15	38x10x38	8	4
	14	42,000	15x15x9	38x38x23	21	10
	26	78,000	15x15x18	38x38x46	39	18



For further information contact:  
Sales at Central Semiconductor Corp.  
(631) 435-1110 or visit:  
[www.centrasemi.com](http://www.centrasemi.com)