

# Package Details

## TLM322 Case

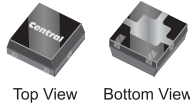

### Mechanical Drawing

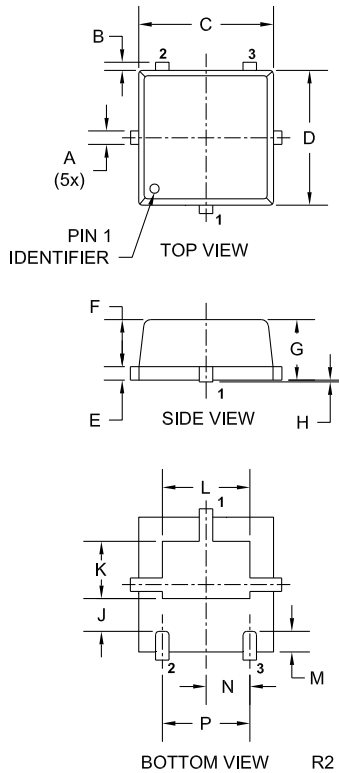

| SYMBOL | DIMENSIONS |       |             |       |
|--------|------------|-------|-------------|-------|
|        | INCHES     |       | MILLIMETERS |       |
|        | MIN        | MAX   | MIN         | MAX   |
| A      | 0.007      | 0.012 | 0.17        | 0.30  |
| B      | ---        | 0.005 | ---         | 0.125 |
| C      | 0.075      | 0.083 | 1.90        | 2.10  |
| D      | 0.075      | 0.083 | 1.90        | 2.10  |
| E      | 0.006      | 0.010 | 0.15        | 0.25  |
| F      | 0.026      | 0.030 | 0.65        | 0.75  |
| G      | 0.031      | 0.039 | 0.80        | 1.00  |
| H      | 0.000      | 0.002 | 0.00        | 0.05  |
| J      | 0.024      |       | 0.60        |       |
| K      | 0.031      | 0.035 | 0.79        | 0.89  |
| L      | 0.048      | 0.056 | 1.22        | 1.42  |
| M      | 0.008      | 0.018 | 0.20        | 0.45  |
| N      | 0.026      |       | 0.65        |       |
| P      | 0.051      |       | 1.30        |       |

TLM322 (REV:R2)

#### Part Marking:

2-3 Character Alpha/Numeric Code

#### Lead Code:

Reference individual device datasheet.

### Mounting Pad Geometry (Dimensions in mm)

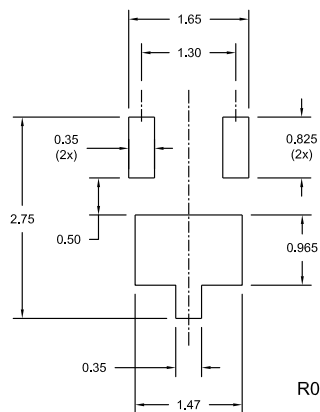

R1 (4-March 2010)

# Package Details

## TLM322 Case



### Tape Dimensions and Orientation (Dimensions in mm)

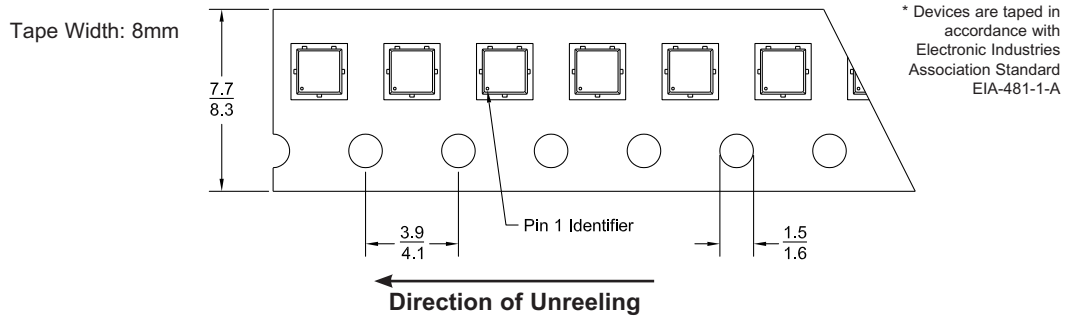

### Packaging Base

7" Reel = 3,000 pcs.

### Reel Labeling Information

**Each reel is labeled with the following information:**

Central Part Number, Customer Part Number, Purchase Order Number, Quantity, Lot Number, Date Code, Ship Date and Marking Code.

### Reel Packing Information

| Reel Size | Reels per Box (Maximum) | Parts per Box (Maximum) | Box Dimensions |          | Shipping Weight (Max.) |    |
|-----------|-------------------------|-------------------------|----------------|----------|------------------------|----|
|           |                         |                         | INCH           | CM       | LB                     | KG |
| 7"        | 9                       | 27,000                  | 9x9x5          | 23x23x13 | 4                      | 2  |
|           | 17                      | 51,000                  | 9x9x9          | 23x23x23 | 7                      | 4  |
|           | 40                      | 120,000                 | 21x9x9         | 53x23x23 | 14                     | 7  |
|           | 108                     | 324,000                 | 27x9x17        | 69x23x43 | 39                     | 18 |

### Ordering Information

- For devices taped and reeled on 7" reels, add TR suffix to part number.
- All SMDs are available in small quantities for prototype and manual placement applications.

R1 (4-March 2010)