

Package Details - DO-15

Mechanical Drawing

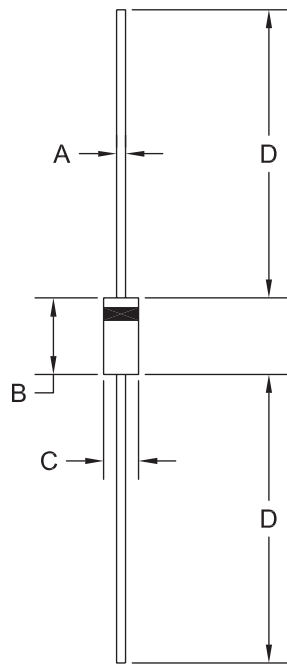

SYMBOL	INCHES		MILLIMETERS	
	MIN	MAX	MIN	MAX
A	0.028	0.034	0.71	0.86
B	0.230	0.300	5.84	7.62
C	0.104	0.140	2.64	3.56
D	1.000	-	25.40	-

DO-15 (REV: R1)

Lead Code:
Cathode band

R1

Packing options:

Bulk - Packing Code: D

D = White corrugated box with black conductive coating (surface resistivity of $<10^5$ ohms per square).

Bulk Packing Quantity: 1,000

Tape and Reel - Packing Code: A

A = Axial taped and reeled in accordance with EIA-296-E. If required, individual reels placed in poly antistatic coated bags (surface resistivity of $>10^9$ and $<10^{13}$ ohms per square).

Tape and Reel Packing Quantity: 4,000

Material Composition Specification

DO-15 Case

Available with Pb (lead)-free plating*



Device average mass 420 mg
Fluctuation margin +/-10%

Device part	Substance	mass (mg)
active device	doped Si	1.90
leadframe	Copper Alloy	303
die attach	Pb92.5Ag2.5Sn5	1.30
*plating	SnPb10 or Sn (100% tin, Pb-free)	4.80 4.80
encapsulation	partially brominated epoxy -silica -epoxy < 20% -resin < 10% -Sb ₂ O ₃ < 1.0%	109

* specify Lead-free when ordering 100% tin (Pb-free) plating option.