

Package Details - Case 106

Mechanical Drawing

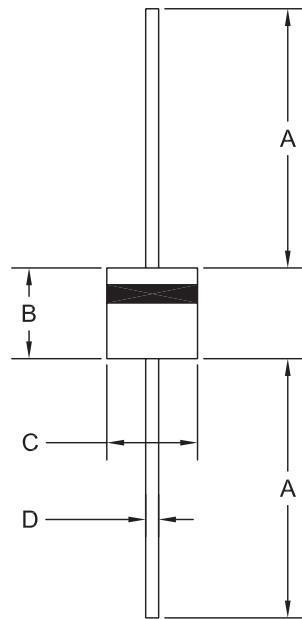

DIMENSIONS				
SYMBOL	INCHES		MILLIMETERS	
	MIN	MAX	MIN	MAX
A	1.000	-	25.40	-
B	0.340	0.360	8.64	9.14
C	0.340	0.360	8.64	9.14
D	0.048	0.053	1.22	1.35

CASE 106 (REV: R1)

Lead Code:
Cathode band

R1

Packing options:

Bulk - Packing Code: D

D = White corrugated box with black conductive coating (surface resistivity of $<10^5$ ohms per square).

Bulk Packing Quantity: 250

Tape and Reel - Packing Code: A

A = Axial taped and reeled in accordance with EIA-296-E. If required, individual reels placed in poly antistatic coated bags (surface resistivity of $>10^9$ and $<10^{13}$ ohms per square).

Tape and Reel Packing Quantity: 800